

MOTOR DATA @ 460 VAC (TRAP)

| MOTOR PARAMETERS | UNITS | VALUE |
|---------------------------|--|-----------------|
| MOTOR HORSEPOWER | HP | 1.8 |
| KILOWATTS | KW | 1.33 |
| MAX. OPERATING SPEED | N MAX | 2100 |
| SPEED @ RATED TORQUE | N RATED | 1500 |
| * CONTINUOUS RATED TORQUE | IN-LBS [Nm] | 75.0 [8.4] |
| * CONTINUOUS STALL TORQUE | IN-LBS [Nm] | 83.0 [9.3] |
| CONTINUOUS LINE CURRENT | AMPS | 3.5 |
| PEAK CURRENT | IN-LBS [Nm] | 290.0 [32.7] |
| MAX. THEORETICAL ACCEL | AMPS | 11.7 |
| TORQUE SENSITIVITY | RD/SECT | 44.015 |
| BACK EMF (LINE TO LINE) | IN-LBS/AMF [Nm/AMF] | 24.812 [8.4] |
| D.G. RESISTANCE (P-P) | Vrms/Krpm | 220.0 |
| INDUCTANCE (P-P) | OHMS | 6.3 |
| ROTOR INERTIA | MILLIHENRIES | 47.4 |
| STATIC FRICTION | IN-LBS-SEC ² [Kg-M ²] | .00681 [0.0074] |
| | IN-LBS [Nm] | 1.41 [1.6] |

*25°C AMBIENT WITH A MAXIMUM CASE TEMPERATURE OF 100°C ON MOTOR. MOTOR MOUNTED ON A 12" X 12" X 1/2" ALUMINUM HEATSINK. THERMOSTAT IN STATOR WINDINGS WILL OPEN IF WINDING TEMPERATURE EXCEEDS 155°C. THIS ALLOWS FOR AN APPROXIMATE +10% HEADROOM IN THE CONTINUOUS TORQUE RATING BEFORE THERMOSTAT OPENS.

- MECHANICAL NOTES:**
- AXIAL LEAD: 50 LBS MAX
 - RADIAL LOAD: 100 LBS MAX @ 1" FROM FACE
 - MOTOR SEALED TO IP65.
 - MOTOR WEIGHT: 26.8 LBS. [12.1 Kg]
 - MOTOR FINISH: BLACK EPOXY
 - MOTOR OUTPUT SHAFT: STAINLESS STEEL
 - INCHES (MILLIMETERS)

ENCODER: (290-00052)
DH48-200DP8-LB-3V

CONNECTION CHART

MOTOR CONNECTOR:
PT02E-14-9P(027)
(270-00026)

| MOTOR WIRE LEADS | WIRE FUNCTION | WIRE COLOR |
|------------------|---------------|------------|
| A | φR | RED |
| B | φS | BLACK |
| C | φT | BLUE |
| D | PE GND | GRN/YEL |
| E | - | - |

ENCODER/THERM CONNECTOR:
PT02E-14-18P(027)
(270-00024)

| ENC/THERM WIRE LEADS | WIRE FUNCTION | WIRE COLOR |
|----------------------|---------------|------------|
| T | GROUND | BLACK |
| K | +5VDC | RED |
| B | CH A | BLUE |
| C | CH A | BLUE/BLK |
| N | CH B | GREEN |
| P | CH B | GRN/BLK |
| M | CH Z | YELLOW |
| U | CH Z | YEL/BLK |
| E | CH U | BROWN |
| R | CH U | BRN/BLK |
| F | CH V | GRAY |
| S | CH V | GRAY/BLK |
| G | CH W | WHITE |
| H | CH W | WHT/BLK |
| D | GND/CABLE | SHLD |
| A | THERM | BLACK |
| L | THERM | BLACK |
| J | GND | GRN/YEL |

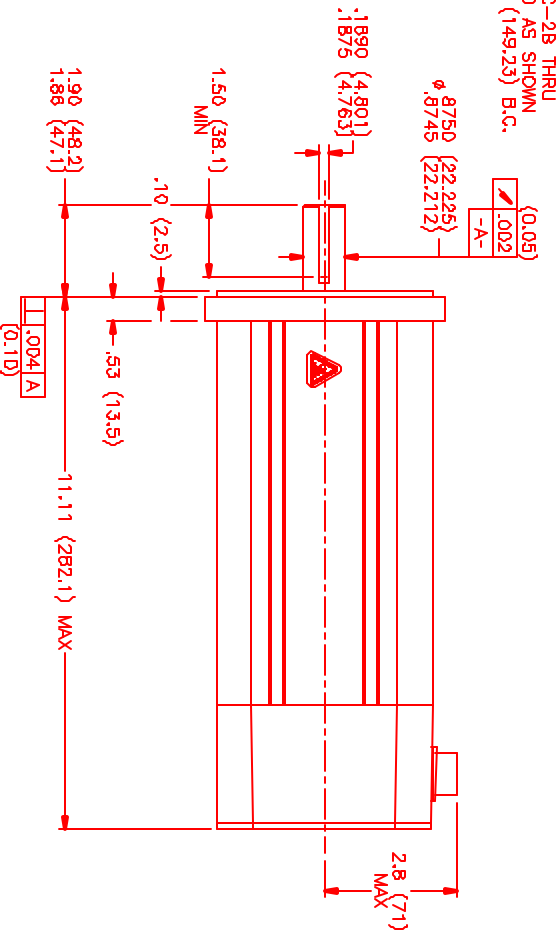
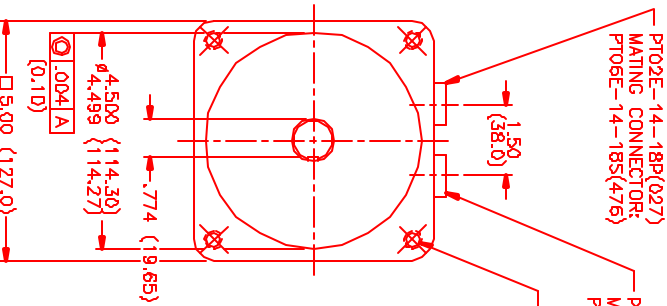

*MOTOR ROTATION COW (COUNTER CLOCKWISE)
(LOOKING AT THE FACE OF THE MOTOR)



| HALL LEADS | BROWN | GRAY | WHITE |
|--------------------------|---------------------|--------------------|----------------------|
| MOTOR LEADS | BLACK mapped to RED | RED mapped to BLUE | BLUE mapped to BLACK |
| VIEW ON THE OSCILLOSCOPE | AAAA | AAAA | AAAA |

MOTOR & HALL POSITION CHART

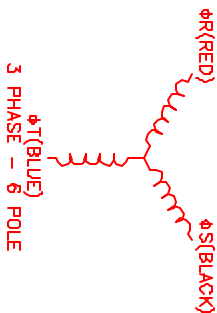

REV 1/2/1

| REV | REVISION | DATE | APP'D. |
|-----|-------------|--------|--------|
| 1 | REVISION | 2/9/99 | M/S |
| | PRELIMINARY | | |

| NO. | PART NUMBER | DESCRIPTION | QTY. |
|-----|-------------|--|------|
| 1 | M/S | M/S Systems Corporation Automation Division | |
| 2 | DP | DP/TRAP/460/ENC/72/COMN | |
| 3 | ENC | ENC | |
| 4 | REV | REV | |
| 5 | DATE | DATE | |
| 6 | REV | REV | |
| 7 | DATE | DATE | |
| 8 | REV | REV | |
| 9 | DATE | DATE | |
| 10 | REV | REV | |
| 11 | DATE | DATE | |
| 12 | REV | REV | |
| 13 | DATE | DATE | |
| 14 | REV | REV | |
| 15 | DATE | DATE | |
| 16 | REV | REV | |
| 17 | DATE | DATE | |
| 18 | REV | REV | |
| 19 | DATE | DATE | |
| 20 | REV | REV | |
| 21 | DATE | DATE | |
| 22 | REV | REV | |
| 23 | DATE | DATE | |
| 24 | REV | REV | |
| 25 | DATE | DATE | |
| 26 | REV | REV | |
| 27 | DATE | DATE | |
| 28 | REV | REV | |
| 29 | DATE | DATE | |
| 30 | REV | REV | |
| 31 | DATE | DATE | |
| 32 | REV | REV | |
| 33 | DATE | DATE | |
| 34 | REV | REV | |
| 35 | DATE | DATE | |
| 36 | REV | REV | |
| 37 | DATE | DATE | |
| 38 | REV | REV | |
| 39 | DATE | DATE | |
| 40 | REV | REV | |
| 41 | DATE | DATE | |
| 42 | REV | REV | |
| 43 | DATE | DATE | |
| 44 | REV | REV | |
| 45 | DATE | DATE | |
| 46 | REV | REV | |
| 47 | DATE | DATE | |
| 48 | REV | REV | |
| 49 | DATE | DATE | |
| 50 | REV | REV | |
| 51 | DATE | DATE | |
| 52 | REV | REV | |
| 53 | DATE | DATE | |
| 54 | REV | REV | |
| 55 | DATE | DATE | |
| 56 | REV | REV | |
| 57 | DATE | DATE | |
| 58 | REV | REV | |
| 59 | DATE | DATE | |
| 60 | REV | REV | |
| 61 | DATE | DATE | |
| 62 | REV | REV | |
| 63 | DATE | DATE | |
| 64 | REV | REV | |
| 65 | DATE | DATE | |
| 66 | REV | REV | |
| 67 | DATE | DATE | |
| 68 | REV | REV | |
| 69 | DATE | DATE | |
| 70 | REV | REV | |
| 71 | DATE | DATE | |
| 72 | REV | REV | |
| 73 | DATE | DATE | |
| 74 | REV | REV | |
| 75 | DATE | DATE | |
| 76 | REV | REV | |
| 77 | DATE | DATE | |
| 78 | REV | REV | |
| 79 | DATE | DATE | |
| 80 | REV | REV | |
| 81 | DATE | DATE | |
| 82 | REV | REV | |
| 83 | DATE | DATE | |
| 84 | REV | REV | |
| 85 | DATE | DATE | |
| 86 | REV | REV | |
| 87 | DATE | DATE | |
| 88 | REV | REV | |
| 89 | DATE | DATE | |
| 90 | REV | REV | |
| 91 | DATE | DATE | |
| 92 | REV | REV | |
| 93 | DATE | DATE | |
| 94 | REV | REV | |
| 95 | DATE | DATE | |
| 96 | REV | REV | |
| 97 | DATE | DATE | |
| 98 | REV | REV | |
| 99 | DATE | DATE | |
| 100 | REV | REV | |