

MOTOR DATA @ 110 VAC (TRAP)		
MOTOR PARAMETERS	UNITS	VALUE
HORSEPOWER	HP RATED	.22
KILOWATTS	KW RATED	.16
MAX. OPERATING SPEED	N. MAX RPM	5000
SPEED @ RATED TORQUE	N RATED RPM	4000
* CONTINUOUS RATED TORQUE @ 4000 RPM	IN-LBS[Nm]	3.4 [3.8]
* CONTINUOUS STALL TORQUE	IN-LBS[Nm]	5.0 [5.6]
CONTINUOUS LINE CURRENT	AMPS	2.5
PEAK TORQUE	IN-LBS[Nm]	15.1 [1.7]
PEAK CURRENT	AMPS	7.6
MAX. THEORETICAL ACCEL.	RAD/SEC ²	155,670
TORQUE SENSITIVITY	Kt [IN-LBS/AMPI Nm/AMP]	2.0 [2.3]
BACK EMF (LINE TO LINE)	Vrms/Krpm	17.8
D.C. RESISTANCE (P-P)	OHMS	8.4
INDUCTANCE (P-P)	MILLIHENRIES	11.6
ROTOR INERTIA	Jm [IN-LBS-SEC ²] Kg-M ²	.000097 [0.0000109]
STATIC FRICTION	Tf [IN-LBS] [Nm]	.5 [0.6]

*25°C AMBIENT WITH A MAXIMUM CASE TEMPERATURE OF 100°C ON MOTOR. MOTOR MOUNTED ON A 10" X 10" X 1/4" ALUMINUM HEATSINK. THERMOSTAT IN STATOR WINDINGS WILL OPEN IF WINDING TEMPERATURE EXCEEDS 155°C. THIS ALLOWS FOR AN APPROXIMATE +10% HEADROOM IN THE CONTINUOUS TORQUE RATING BEFORE THERMOSTAT OPENS.

MECHANICAL NOTES:

1. AXIAL PLAY: 15 LBS MAX
2. RADIAL PLAY: 20 LBS MAX @ 1" FROM FACE
3. MOTOR SEALED TO IP65.
4. MOTOR WEIGHT: 2.8 LBS. [1.3 kg]
5. MOTOR FINISH: BLACK EPOXY
6. MOTOR OUTPUT SHAFT: STAINLESS STEEL
7. MILLIMETERS (INCHES)

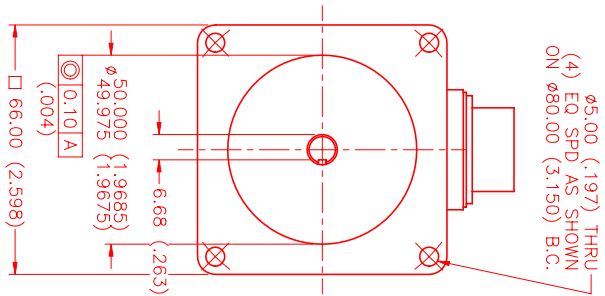

(4) EQ. SPD. AS SHOWN ON Ø80.00 (3.150) B.C.

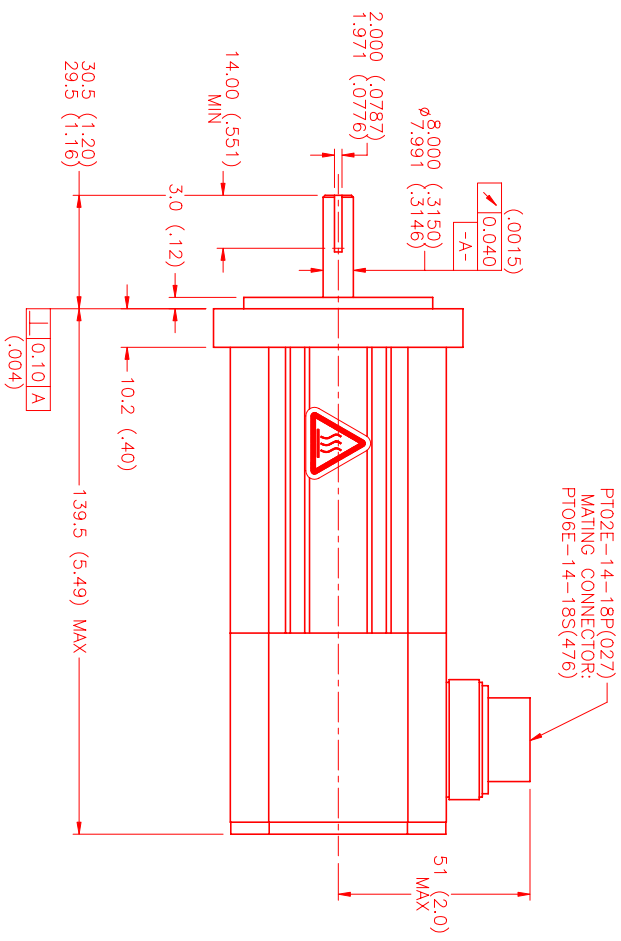

PT02E-14-18P(027)
MATING CONNECTOR:
PT06E-14-18S(476)

CONNECTION CHART
MOTOR/THERM/RESOLVER CONNECTOR:
PT02E-14-18P(027)
(270-00024)

MTR/PIN	THERM/FUNCTION	RES/WIRE	RES/WIRE
		FUNCTION	COLOR
A	ΦR	RED	RED
B	ΦS	BLACK	BLACK
C	ΦT	BLUE	BLUE
D	PE GND	GRN/YEL	GRN/YEL
N	THERM	BLACK	BLACK
H	SIN	YELLOW	YELLOW
G	COS GND	BLACK	BLACK
S	COS	RED	RED
F	SIN GND	BLUE	BLUE
R	REF GND	YEL/WHI	YEL/WHI
E	REF	RED/WHI	RED/WHI
J	RES. SHLD	GRN/YEL	GRN/YEL
K	-	-	-
L	-	-	-
M	-	-	-
P	-	-	-
T	-	-	-

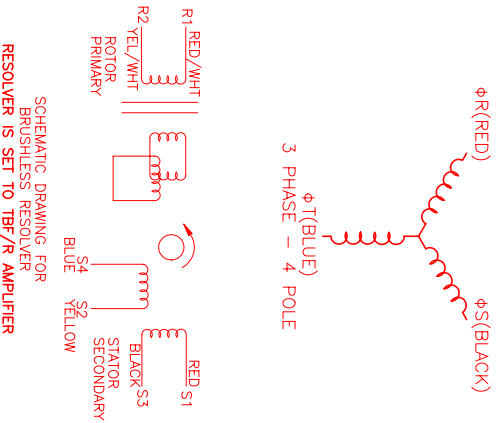

SCHEMATIC DRAWING FOR
BRUSHLESS RESOLVER
RESOLVER IS SET TO TBR/R AMPIFIER

REV#	DESCRIPTION	DATE	APPD.
PRELIMINARY		7/30/01	LIN

NO.	PART NUMBER	DESCRIPTION	QTY.
UNLESS SPECIFIED			
DECIMAL ANGLES	30° & 45°		
DECIMAL ANGLES	1/2°		
ISO	7/30/01		
CHECKED			
APPROVED			

MTS
Automation Division

MTS Systems Corporation
MPPM62ATF7H1N
SCALE: 1:1