

② MOTOR DATA @ 230 VAC (SINE)

MOTOR PARAMETERS	UNITS	VALUE
HP RATED	HP	.48
KW RATED	KW	.35
MAX. OPERATING SPEED	N MAX	6000
SPEED @ RATED TORQUE	N RATED	5000
* CONTINUOUS RATED TORQUE @ 5000 RPM	IN-LBS [Nm]	6.0 [0.68]
* CONTINUOUS LINE CURRENT	IN-LBS [Nm]	10.0 [1.13]
CONTINUOUS LINE CURRENT	AMPS (RMS/Φ)	2.2
PEAK TORQUE	IN-LBS [Nm]	30.0 [3.4]
PEAK CURRENT	AMPS (RMS/Φ)	6.6
MAX. THEORETICAL ACCEL.	RAD/SEC ²	188,679
TORQUE SENSITIVITY	Kt [IN-LBS/AMP (RMS/Φ) / (Nm/AMP (RMS/Φ))]	4.5 [0.51]
BACK EMF (LINE TO LINE)	Vrms /Krpm	28.3
D.C. RESISTANCE (P-P)	OHMS	7.0
INDUCTANCE (P-P)	MILLIHENRIES	11.0
ROTOR INERTIA	Jm [IN-LBS-SEC ² [Kg-M ²]]	0.000159 [0.0000179]
STATIC FRICTION	Tf [IN-LBS [Nm]]	0.8 [0.09]

*25°C AMBIENT WITH A MAXIMUM CASE TEMPERATURE OF 100°C ON MOTOR. MOTOR MOUNTED ON A 10" X 10" X 1/4" ALUMINUM HEATSINK. THERMOSTAT IN STATOR WINDINGS WILL OPEN IF WINDING TEMPERATURE EXCEEDS 155°C. THIS ALLOWS FOR AN APPROXIMATE +10% HEADROOM IN THE CONTINUOUS TORQUE RATING BEFORE THERMOSTAT OPENS.

MECHANICAL NOTES:

1. AXIAL LOAD: 15 LBS MAX
2. RADIAL LOAD: 20 LBS MAX @ 1" FROM FACE
3. MOTOR SEALED TO IP65.
4. MOTOR WEIGHT: 3.8 LBS [1.7 Kg]
5. MOTOR FINISH: BLACK EPOXY
6. MOTOR OUTPUT SHAFT: STAINLESS STEEL
7. MILLIMETERS (INCHES)

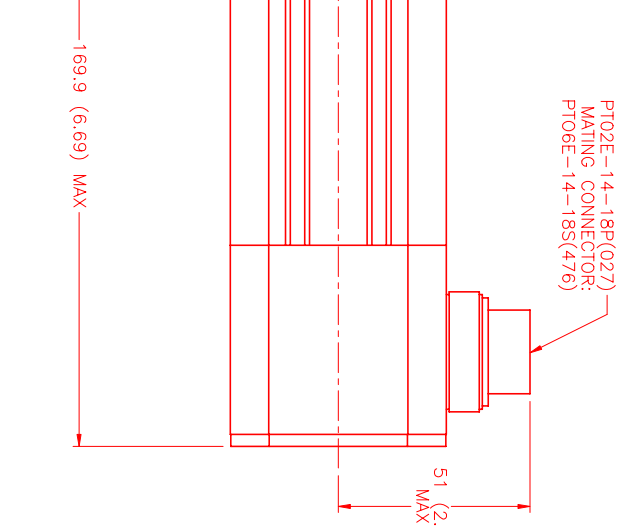
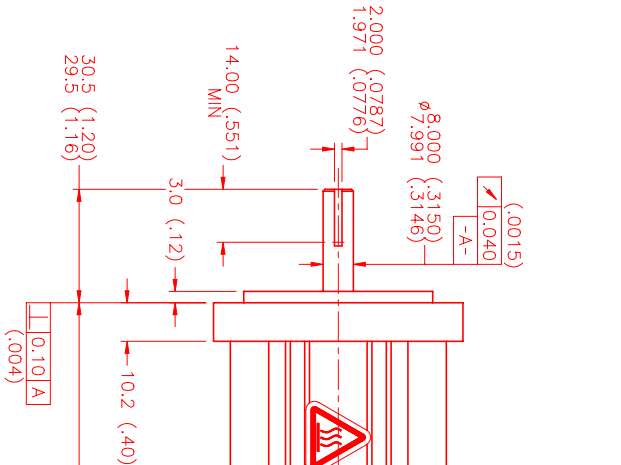
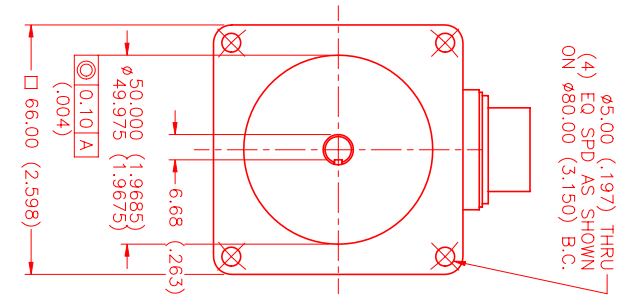

CONNECTION CHART
MOTOR/THERM/RESOLVER CONNECTOR:
PT02E-14-18P(027)
(270-00024)

MTR/THERM/RES	WIRE	WIRE LEADS
PIN	FUNCTION	WIRE COLOR
A	ΦR	RED
B	ΦS	BLACK
C	ΦT	BLUE
D	PE GND	GRN/YEL
U	THERM	BLACK
N	THERM	BLACK
H	SIN	YELLOW
G	COS GND	BLACK
S	COS	RED
F	SIN GND	BLUE
R	REF GND	YEL/WHI
E	REF	RED/WHI
J	RES SHLD	GRN/YEL
K	-	-
L	-	-
M	-	-
P	-	-
T	-	-

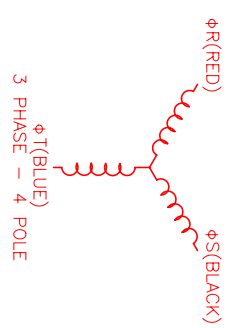
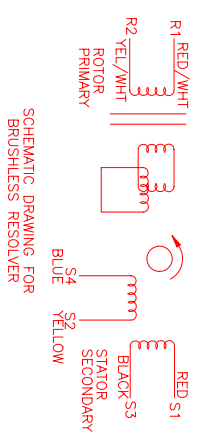

REV.	DESCRIPTION	DATE	APPD.
A	E.C.O. - 584	8/1/00	MWS

NO.	PART NUMBER	DESCRIPTION	QTY.
UNLESS SPECIFIED			
DECIMAL: .005			
FRACTIONAL: 1/32			
ANGLE: 1/2°			
DRAWN: MWS			
CHECKED: MWS			
DATE: 12/28/99			
TITLE: "B"/SINE/230/MET/RES/CONN			
DRAWING NUMBER: MPM664BSG7G1N			
SCALE: 1:1			