

MOTOR DATA @ 230 VAC (SINE)

MOTOR PARAMETERS	UNITS	VALUE
MOTOR HORSEPOWER	HP RATED	0.91
	KW RATED	0.68
MAX. OPERATING SPEED	N. MAX RPM	6300
SPEED @ RATED TORQUE	N RATED RPM	4500
* CONTINUOUS RATED TORQUE @ 4000 RPM	IN-LBS[Nm]	12.8[1.47]
* CONTINUOUS STALL TORQUE	IN-LBS[Nm]	15.0[1.69]
CONTINUOUS LINE CURRENT	AMPS(RMS/φ)	3.6
PEAK TORQUE	IN-LBS[Nm]	45.0[5.1]
PEAK CURRENT	AMPS(RMS/φ)	10.6
MAX. THEORETICAL ACCEL.	RAD/SEC ²	120,000
TORQUE SENSITIVITY	Kt [N-LBS/AMP(RMS)/φ][Nm/AMP(RMS/φ)]	4.19[0.473]
BACK EMF (LINE TO LINE)	±10% Vrms/Krpm	26.3
D.C. RESISTANCE (P-P)	±10% OHMS	2.2
INDUCTANCE (P-P)	±10% MILLIHENRIES	4.9
ROTOR INERTIA W/BRAKE	Jm [IN-LBS-SEC ²][Kg-M ²]	0.00045[0.000051]
STATIC FRICTION	Tf [IN-LBS][Nm]	1.0[0.11]

*25°C AMBIENT WITH A MAXIMUM CASE TEMPERATURE OF 85°C ON MOTOR. MOTOR MOUNTED ON A 12" X 12" X 1/2" ALUMINUM HEATSINK. THERMOSTAT IN STATOR WINDINGS WILL OPEN IF WINDING TEMPERATURE EXCEEDS 155°C. THIS ALLOWS FOR AN APPROXIMATE +10% HEADROOM IN THE CONTINUOUS TORQUE RATING BEFORE THERMOSTAT OPENS.

MECHANICAL NOTES:

- AXIAL LOAD: 20 LBS. MAX
- RADIAL LOAD: 35 LBS. MAX @ 1" FROM FACE
- MOTOR SEALED TO IP65.
- MOTOR WEIGHT: 6.3 LBS. [2.9 Kg]
- MOTOR FINISH: BLACK EPOXY
- MOTOR OUTPUT SHAFT: STAINLESS STEEL
- MILLIMETERS (INCHES)
- THIS MOTOR'S OUTPUT KEY IS A PRESS FIT.

FAILSAFE BRAKE:

MIN. HOLDING TORQUE: 24 IN-LBS
INPUT VOLTAGE: 24 VOLTS

ENCODER: (290-00158)

0IH35-2048P6-L6-5V

CONNECTION CHART

MOTOR/THERM/ENC/BRK CONNECTOR:
PT02E-16-23P(027)
(270-00219)

MTR/ENC/THERM/BRK	WIRE FUNCTION	WIRE COLOR	WIRE LEADS
A	φR	RED	
B	φS	BLACK	
C	φT	BLUE	
D	PE GND	GRN/YEL	
T	GROUND	BLACK	
E	+5VDC	RED	
F	CH A	BLUE	
U	CH A \	BLUE/BLK	
G	CH B	GREEN	
V	CH B \	GRN/BLK	
H	CH Z	YELLOW	
W	CH Z \	YEL/BLK	
J	CH U	BROWN	
K	CH U \	BRN/BLK	
X	CH V	GRAY	
L	CH V \	GRAY/BLK	
Y	CH W	WHITE	
M	CH W \	WHT/BLK	
N	GND/CABLE	SHLD	
S	THERM	BLACK	
R	THERM	BLACK	
P	BRK (+)	DIODE	
Z	BRK (-)	1N4007	

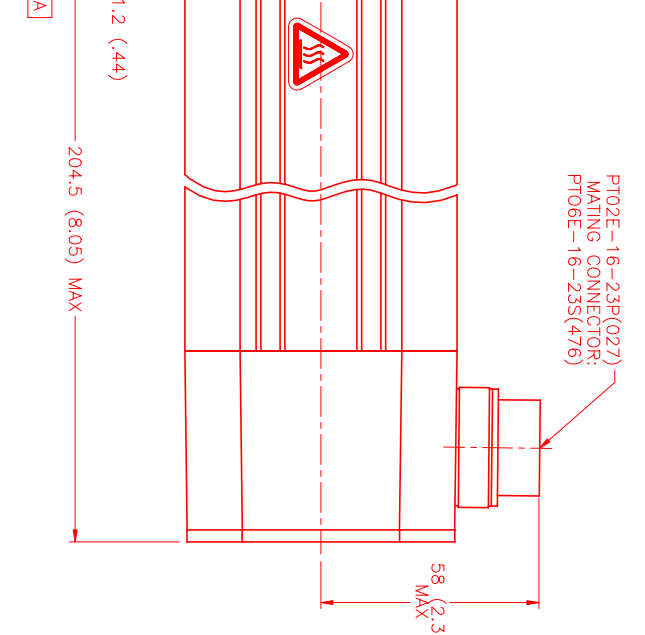
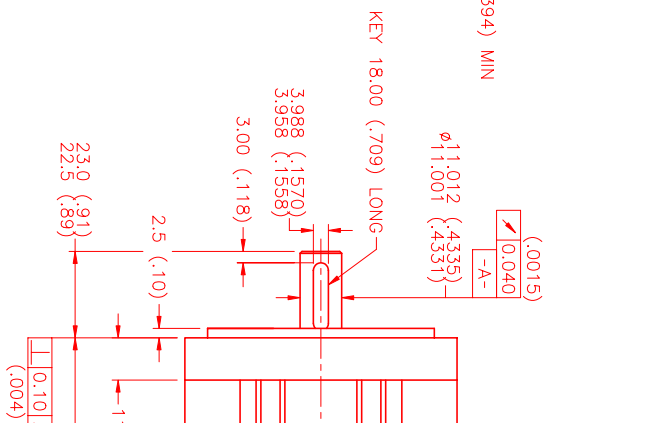
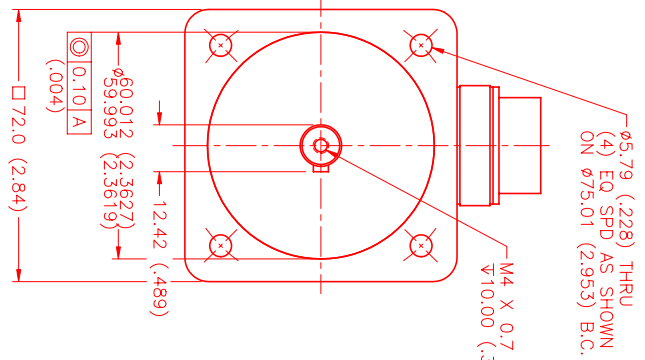

PT02E-16-23P(027)
MATING CONNECTOR:
PT06E-16-23S(476)

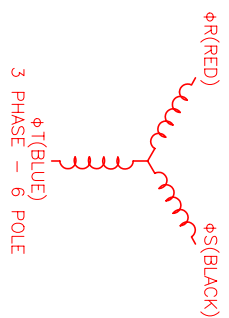

NO.	PART NUMBER	DESCRIPTION	QTY.
1	290-00158	ENCODER	1
2	290-00158	ENCODER	1
3	290-00158	ENCODER	1
4	290-00158	ENCODER	1
5	290-00158	ENCODER	1
6	290-00158	ENCODER	1
7	290-00158	ENCODER	1
8	290-00158	ENCODER	1
9	290-00158	ENCODER	1
10	290-00158	ENCODER	1
11	290-00158	ENCODER	1
12	290-00158	ENCODER	1
13	290-00158	ENCODER	1
14	290-00158	ENCODER	1
15	290-00158	ENCODER	1
16	290-00158	ENCODER	1
17	290-00158	ENCODER	1
18	290-00158	ENCODER	1
19	290-00158	ENCODER	1
20	290-00158	ENCODER	1
21	290-00158	ENCODER	1
22	290-00158	ENCODER	1
23	290-00158	ENCODER	1
24	290-00158	ENCODER	1
25	290-00158	ENCODER	1
26	290-00158	ENCODER	1
27	290-00158	ENCODER	1
28	290-00158	ENCODER	1
29	290-00158	ENCODER	1
30	290-00158	ENCODER	1
31	290-00158	ENCODER	1
32	290-00158	ENCODER	1
33	290-00158	ENCODER	1
34	290-00158	ENCODER	1
35	290-00158	ENCODER	1
36	290-00158	ENCODER	1
37	290-00158	ENCODER	1
38	290-00158	ENCODER	1
39	290-00158	ENCODER	1
40	290-00158	ENCODER	1
41	290-00158	ENCODER	1
42	290-00158	ENCODER	1
43	290-00158	ENCODER	1
44	290-00158	ENCODER	1
45	290-00158	ENCODER	1
46	290-00158	ENCODER	1
47	290-00158	ENCODER	1
48	290-00158	ENCODER	1
49	290-00158	ENCODER	1
50	290-00158	ENCODER	1
51	290-00158	ENCODER	1
52	290-00158	ENCODER	1
53	290-00158	ENCODER	1
54	290-00158	ENCODER	1
55	290-00158	ENCODER	1
56	290-00158	ENCODER	1
57	290-00158	ENCODER	1
58	290-00158	ENCODER	1
59	290-00158	ENCODER	1
60	290-00158	ENCODER	1
61	290-00158	ENCODER	1
62	290-00158	ENCODER	1
63	290-00158	ENCODER	1
64	290-00158	ENCODER	1
65	290-00158	ENCODER	1
66	290-00158	ENCODER	1
67	290-00158	ENCODER	1
68	290-00158	ENCODER	1
69	290-00158	ENCODER	1
70	290-00158	ENCODER	1
71	290-00158	ENCODER	1
72	290-00158	ENCODER	1
73	290-00158	ENCODER	1
74	290-00158	ENCODER	1
75	290-00158	ENCODER	1
76	290-00158	ENCODER	1
77	290-00158	ENCODER	1
78	290-00158	ENCODER	1
79	290-00158	ENCODER	1
80	290-00158	ENCODER	1
81	290-00158	ENCODER	1
82	290-00158	ENCODER	1
83	290-00158	ENCODER	1
84	290-00158	ENCODER	1
85	290-00158	ENCODER	1
86	290-00158	ENCODER	1
87	290-00158	ENCODER	1
88	290-00158	ENCODER	1
89	290-00158	ENCODER	1
90	290-00158	ENCODER	1
91	290-00158	ENCODER	1
92	290-00158	ENCODER	1
93	290-00158	ENCODER	1
94	290-00158	ENCODER	1
95	290-00158	ENCODER	1
96	290-00158	ENCODER	1
97	290-00158	ENCODER	1
98	290-00158	ENCODER	1
99	290-00158	ENCODER	1
100	290-00158	ENCODER	1

REV.	DESCRIPTION	DATE	APP.
PRELIMINARY		5/31/00	MVS

NO.	PART NUMBER	DESCRIPTION	QTY.
1	290-00158	ENCODER	1
2	290-00158	ENCODER	1
3	290-00158	ENCODER	1
4	290-00158	ENCODER	1
5	290-00158	ENCODER	1
6	290-00158	ENCODER	1
7	290-00158	ENCODER	1
8	290-00158	ENCODER	1
9	290-00158	ENCODER	1
10	290-00158	ENCODER	1
11	290-00158	ENCODER	1
12	290-00158	ENCODER	1
13	290-00158	ENCODER	1
14	290-00158	ENCODER	1
15	290-00158	ENCODER	1
16	290-00158	ENCODER	1
17	290-00158	ENCODER	1
18	290-00158	ENCODER	1
19	290-00158	ENCODER	1
20	290-00158	ENCODER	1
21	290-00158	ENCODER	1
22	290-00158	ENCODER	1
23	290-00158	ENCODER	1
24	290-00158	ENCODER	1
25	290-00158	ENCODER	1
26	290-00158	ENCODER	1
27	290-00158	ENCODER	1
28	290-00158	ENCODER	1
29	290-00158	ENCODER	1
30	290-00158	ENCODER	1
31	290-00158	ENCODER	1
32	290-00158	ENCODER	1
33	290-00158	ENCODER	1
34	290-00158	ENCODER	1
35	290-00158	ENCODER	1
36	290-00158	ENCODER	1
37	290-00158	ENCODER	1
38	290-00158	ENCODER	1
39	290-00158	ENCODER	1
40	290-00158	ENCODER	1
41	290-00158	ENCODER	1
42	290-00158	ENCODER	1
43	290-00158	ENCODER	1
44	290-00158	ENCODER	1
45	290-00158	ENCODER	1
46	290-00158	ENCODER	1
47	290-00158	ENCODER	1
48	290-00158	ENCODER	1
49	290-00158	ENCODER	1
50	290-00158	ENCODER	1
51	290-00158	ENCODER	1
52	290-00158	ENCODER	1
53	290-00158	ENCODER	1
54	290-00158	ENCODER	1
55	290-00158	ENCODER	1
56	290-00158	ENCODER	1
57	290-00158	ENCODER	1
58	290-00158	ENCODER	1
59	290-00158	ENCODER	1
60	290-00158	ENCODER	1
61	290-00158	ENCODER	1
62	290-00158	ENCODER	1
63	290-00158	ENCODER	1
64	290-00158	ENCODER	1
65	290-00158	ENCODER	1
66	290-00158	ENCODER	1
67	290-00158	ENCODER	1
68	290-00158	ENCODER	1
69	290-00158	ENCODER	1
70	290-00158	ENCODER	1
71	290-00158	ENCODER	1
72	290-00158	ENCODER	1
73	290-00158	ENCODER	1
74	290-00158	ENCODER	1
75	290-00158	ENCODER	1
76	290-00158	ENCODER	1
77	290-00158	ENCODER	1
78	290-00158	ENCODER	1
79	290-00158	ENCODER	1
80	290-00158	ENCODER	1
81	290-00158	ENCODER	1
82	290-00158	ENCODER	1
83	290-00158	ENCODER	1
84	290-00158	ENCODER	1
85	290-00158	ENCODER	1
86	290-00158	ENCODER	1
87	290-00158	ENCODER	1
88	290-00158	ENCODER	1
89	290-00158	ENCODER	1
90	290-00158	ENCODER	1
91	290-00158	ENCODER	1
92	290-00158	ENCODER	1
93	290-00158	ENCODER	1
94	290-00158	ENCODER	1
95	290-00158	ENCODER	1
96			