

MOTOR DATA @ 230 VAC

MOTOR PARAMETERS	UNITS	VALUE
HORSEPOWER	HP	1.62
KILOWATTS	KW	1.20
MAX. OPERATING SPEED	N. MAX RPM	5000
SPEED @ RATED TORQUE	N RATED RPM	4000
* CONTINUOUS RATED TORQUE @ 4000 RPM	IN-LBS[Nm]	25.5[2.9]
* CONTINUOUS STALL TORQUE	IN-LBS[Nm]	30.0[3.4]
CONTINUOUS LINE CURRENT	AMPS	7.3
PEAK TORQUE	IN-LBS[Nm]	109.9[12.42]
PEAK CURRENT	AMPS	26.8
MAX. THEORETICAL ACCEL.	RAD/SEC ²	96.319
TORQUE SENSITIVITY	Kt IN-LBS/AMPI Nm/AMP	4.11[.47]
BACK EMF (LINE TO LINE)	Vrms/Krpm	36.6
D.C. RESISTANCE (P-P)	OHMS	1.5
INDUCTANCE (P-P)	MILLIHENRIES	5.1
ROTOR INERTIA	Jm [IN-LBS-SEC ²] [Kg-M ²]	.001141[.0001285]
STATIC FRICTION	Tf [IN-LBS] [Nm]	.5[.06]

*25°C AMBIENT WITH A MAXIMUM CASE TEMPERATURE OF 100°C ON MOTOR. MOTOR MOUNTED ON A 10" X 10" X 10" X 1/4" ALUMINUM HEATSINK. THERMOSTAT IN STATOR WINDINGS WILL OPEN IF WINDING TEMPERATURE EXCEEDS 155°C. THIS ALLOWS FOR AN APPROXIMATE +10% HEADROOM IN THE CONTINUOUS TORQUE RATING BEFORE THERMOSTAT OPENS.

MECHANICAL NOTES:

- AXIAL LOAD: 25 LBS MAX
- RADIAL LOAD: 40 LBS MAX @ 1" FROM FACE
- MOTOR SEALED TO IP65.
- MOTOR WEIGHT: 12.2 LBS. [5.5 Kg]
- MOTOR FINISH: BLACK EPOXY
- MOTOR OUTPUT SHAFT: STAINLESS STEEL
- MILLIMETERS (INCHES)

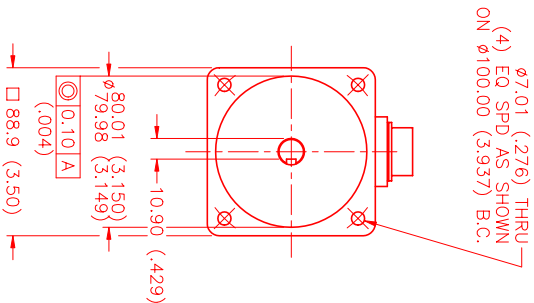

CONNECTION CHART

THERM/RESOLVER CONNECTOR:

MOTOR/BRAKE WIRE LEADS	WIRE FUNCTION	WIRE COLOR
A	φR(U1)	RED
B	φS(V1)	BLACK
C	φT(W1)	BLUE
D	PE GND	GRN/YEL
E	BRK SHLD	-
F	BRK (+)	DIODE
G	BRK (-)	1N4007
H	-	-

THERM/RES WIRE LEADS	PIN	WIRE FUNCTION	WIRE COLOR
A	U	THERM	BLACK
B	N	THERM	BLACK
C	H	SIN(S2)	YELLOW
D	G	COS GND(S1)	BLACK
E	S	COS(S3)	RED
F	R	SIN GND(S4)	BLUE
G	R	REF GND(R2)	YEL/WHI
H	E	REF(R1)	RED/WHI
I	D	RES SHLD	GRN/YEL
J	P	GND	-
K	A	-	-
L	B	-	-
M	C	-	-
N	J	-	-
O	K	-	-
P	L	-	-
Q	M	-	-
R	T	-	-

MOTOR/BRAKE WIRE LEADS	THERM/RES WIRE LEADS
A	U
B	N
C	H
D	G
E	S
F	R
G	R
H	E
I	D
J	P
K	A
L	B
M	C
N	J
O	K
P	L
Q	M
R	T

*THIS CHART IS TO BE USED WITH THE TBF/R AMPLIFIER.

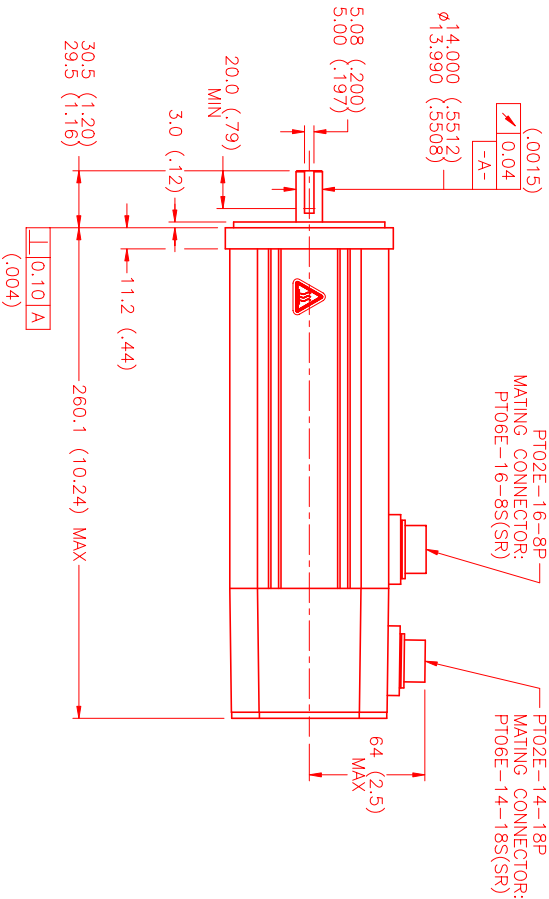
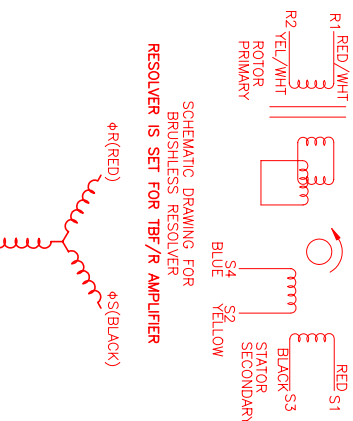

NO. PART NUMBER	DESCRIPTION	QTY.												
1	MOTOR DATA @ 230 VAC													
<table border="1"> <tr> <td>REV.</td> <td>DESCRIPTION</td> <td>DATE</td> <td>APP.</td> </tr> <tr> <td>PRELIMINARY</td> <td></td> <td>7/9/98</td> <td>SW</td> </tr> </table>			REV.	DESCRIPTION	DATE	APP.	PRELIMINARY		7/9/98	SW				
REV.	DESCRIPTION	DATE	APP.											
PRELIMINARY		7/9/98	SW											
<table border="1"> <tr> <td>TITLE:</td> <td>"A"/MET/TBF/CONN/BRK</td> <td>DRAWING NUMBER:</td> <td>MPM892ATG7H1R</td> </tr> <tr> <td>REVISIONS</td> <td></td> <td></td> <td></td> </tr> </table>			TITLE:	"A"/MET/TBF/CONN/BRK	DRAWING NUMBER:	MPM892ATG7H1R	REVISIONS							
TITLE:	"A"/MET/TBF/CONN/BRK	DRAWING NUMBER:	MPM892ATG7H1R											
REVISIONS														
<table border="1"> <tr> <td>NO.</td> <td>PART NUMBER</td> <td>DESCRIPTION</td> <td>QTY.</td> </tr> <tr> <td>1</td> <td>MOTOR DATA @ 230 VAC</td> <td></td> <td></td> </tr> </table>			NO.	PART NUMBER	DESCRIPTION	QTY.	1	MOTOR DATA @ 230 VAC						
NO.	PART NUMBER	DESCRIPTION	QTY.											
1	MOTOR DATA @ 230 VAC													
<table border="1"> <tr> <td>UNLESS SPECIFIED</td> <td></td> </tr> <tr> <td>DECIMAL ANGLES</td> <td>± .005</td> </tr> <tr> <td>FRACTIONAL ANGLES</td> <td>± .002</td> </tr> <tr> <td>DIAMETERS</td> <td>± .002</td> </tr> <tr> <td>HOLES</td> <td>± .002</td> </tr> <tr> <td>ANGLES</td> <td>± 1/2°</td> </tr> </table>			UNLESS SPECIFIED		DECIMAL ANGLES	± .005	FRACTIONAL ANGLES	± .002	DIAMETERS	± .002	HOLES	± .002	ANGLES	± 1/2°
UNLESS SPECIFIED														
DECIMAL ANGLES	± .005													
FRACTIONAL ANGLES	± .002													
DIAMETERS	± .002													
HOLES	± .002													
ANGLES	± 1/2°													
<table border="1"> <tr> <td>DATE:</td> <td>7/9/98</td> </tr> <tr> <td>DESIGNED BY:</td> <td>SW</td> </tr> <tr> <td>CHECKED BY:</td> <td>SW</td> </tr> <tr> <td>TITLE:</td> <td>"A"/230/MET/TBF-RES/CONN/BRK</td> </tr> <tr> <td>DRAWING NUMBER:</td> <td>MPM892ATG7H1R</td> </tr> <tr> <td>SCALE:</td> <td>1/2:1</td> </tr> </table>			DATE:	7/9/98	DESIGNED BY:	SW	CHECKED BY:	SW	TITLE:	"A"/230/MET/TBF-RES/CONN/BRK	DRAWING NUMBER:	MPM892ATG7H1R	SCALE:	1/2:1
DATE:	7/9/98													
DESIGNED BY:	SW													
CHECKED BY:	SW													
TITLE:	"A"/230/MET/TBF-RES/CONN/BRK													
DRAWING NUMBER:	MPM892ATG7H1R													
SCALE:	1/2:1													